

Aldreds
Estate Agents

23 Delph Road

Bradwell, Great Yarmouth, NR31 9GF

Guide Price £315,000



23 Delph Road

Bradwell, Great Yarmouth, NR31

*** GUIDE PRICE £315,000 - £325,000*** A 4 bedroom detached family home, pleasantly positioned in a cul-de-sac with spacious accommodation. The property benefits from gas central heating and UPVC double glazed windows. A door from the kitchen diner leads through to the garage, proving potential to convert part or all of the garage to additional accommodation.

Entrance Hall

Composite entrance door with two double glazed panels and spy hole. Radiator. Electronic thermostat for heating. Wood effect laminate floor. Stairs to first floor landing.

Lounge

15'9" x 10'11" max (4.80m x 3.33m max)

Wood effect laminate floor. Radiator. Television and telephone points. Doors with glazed panels to kitchen/diner.

Kitchen/Diner

18'4" x 10'3" (5.59m x 3.12m)

Granite worktops and breakfast bar with cupboards and drawers below and a stainless steel one and a half bowl sink with mixer tap. Matching upstands. Matching wall cupboards. Built-in electric double oven and grill. Four ring electric hob with granite splashback and a concealed extractor above. Integrated Zanussi dishwasher. Wood effect laminate floor. Radiator. Built-in under stairs storage cupboard with single power point. Door to garage. UPVC double glazed doors to the rear garden.

Utility Room

7'0" x 5'3" (2.13m x 1.60m)

Wood effect worktop with cupboard and drawer below and a utility space with plumbing for washing machine. Wood effect laminate floor. Radiator. Wall mounted gas fired combination boiler. Composite door with double glazed panel to side.

Cloakroom

5'3" x 2'11" (1.60m x 0.89m)

White WC and pedestal hand wash basin with tiled splashback. Wood effect laminate floor. Radiator.

Landing

Built-in airing cupboard. Loft access hatch.

Bedroom 1

11'0" x 10'3" plus recesses (3.35m x 3.12m plus recesses)

Radiator. Built-in over stairs wardrobe/storage cupboard. Large built-in wardrobe.

En-suite Shower Room

Tiled corner shower cubicle with a mixer shower. White pedestal wash basin with tiled splashback and WC. Wood effect flooring. Radiator. Extractor.





Bedroom 2
12'2" x 9'4" (3.71m x 2.84m)
Radiator.

Bedroom 3
9'7" x 9'3" (2.92m x 2.82m)
Radiator.

Bedroom 4
9'7" x 7'2" (2.92m x 2.18m)
Radiator.

Bathroom
6'10" x 6'3" (2.08m x 1.91m)
White suite comprising panelled bath with tiled surround and a mira Azora shower above. Pedestal wash basin with tiled splashback and WC. Wood effect flooring. Chrome towel radiator. Extractor.

Outside

A brick weave driveway provides parking for 2/3 vehicles and leads to an integral single garage with up-and-over door, light and power, door to kitchen/diner. The rear garden is fully enclosed and laid partly to lawn with a raised slate paved patio.

Tenure

Freehold

Services

Mains gas, electricity, water and drainage are connected.

Council Tax

Great Yarmouth Borough Council - Band D

Location

Bradwell is a popular residential area adjoining Gorleston 2 miles from Great Yarmouth Town centre * There are a variety of local shops * Schools * Medical centre * Regular bus services to the main shopping areas * Indoor swimming pool and recreation areas.

Directions

Heading south west through Bradwell on Beccles Road (A143), continue to the roundabout on the edge of Bradwell and take the first exit onto Beaufort Way. Take the first exit off the next roundabout. At the 'T' junction, turn right onto Colby Drive. Take the second turning on the right into Delph Road and follow the road round to the left. The property will be found a short distance along on the left.

Ref: G17966/11/23



Floor Plan

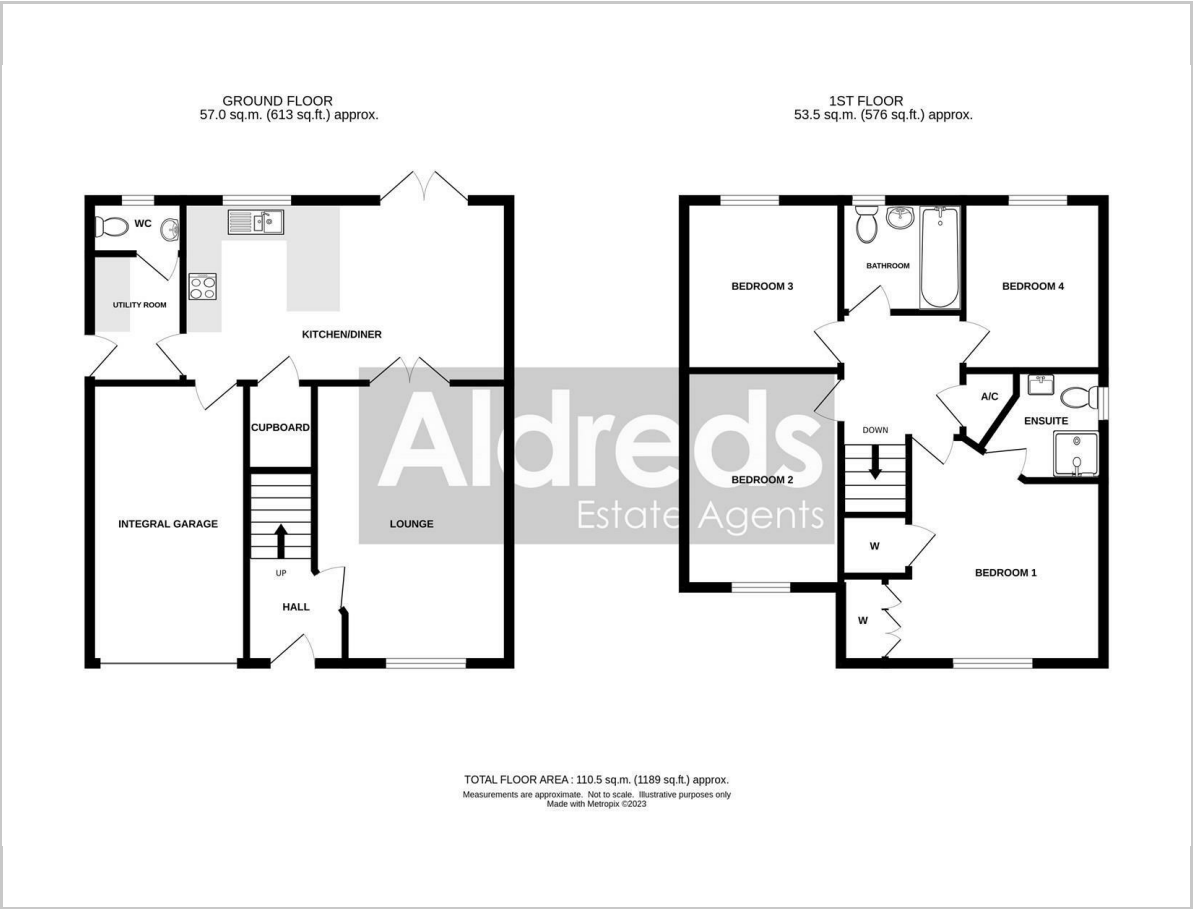

Area Map



Energy Efficiency Graph

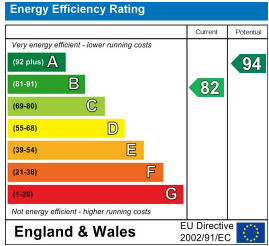

Viewing

Please contact our Aldreds Gorleston Office on 01493 664600 if you wish to arrange a viewing appointment for this property or require further information.

Disclaimer
These particulars are issued on an understanding that all negotiations shall be conducted through Messrs. Aldreds. Please note: Messrs. Aldreds for themselves and for the vendors or lessors of this property whose agents they are given notice that: 1. Particulars are set out as a general outline only for guidance of intending purchasers or lessees, and do not constitute nor constitute part of, an offer or contract. 2. All descriptions, dimensions, references to condition and necessary permissions for use and occupation, and other details are given without responsibility and any intending purchasers or tenants should not rely on them as statements or representations of fact but must satisfy themselves by inspection or otherwise as to the correctness of each of them. 3. No person in the employment of Messrs. Aldreds has any authority to make or give any representation or warranty whatever in relation to this property. 4. If you are proposing to visit the property and are travelling some distance please check with Aldreds on the issue of availability prior to travelling. 5. Aldreds Property Consultants and associated services may offer additional services to the prospective purchaser for which they will be entitled to receive a commission. Aldreds are pleased to be working with Mortgage Advice Bureau. They're an award-winning mortgage broker with over 1,400 advisers across the UK, and have access to over 12,000 mortgage products from over 90 lenders. Aldreds Estate Agents Ltd receive a commission of £200 on each completed case. Your home may be repossessed if you do not keep up repayments on your mortgage. There may be a fee for mortgage advice. The actual amount you pay will depend upon your circumstances. The fee is up to 1%, but a typical fee is 0.3% of the amount borrowed. Mortgage Advice Bureau is a trading name of Mortgage Seeker Limited which is an appointed representative of Mortgage Advice Bureau Limited and Mortgage Advice Bureau (Derby) Limited which are authorised and regulated by the Financial Conduct Authority. Mortgage Seeker Limited Registered Office: Lovewell Blake, Sixty Six North Quay, Great Yarmouth, Norfolk, NR30 1HE. Registered in England Number: 03721415. 6. Potential purchasers should check with their providers that the broadband and mobile phone coverage they would require is available.